



CRE FABRICACIONES, S.A. DE C.V.

 (81) 10 92 05 40

 gruporoca@live.com.mx

 Benito Juárez, N.L., 67286.

Somos Fabricantes de toda clase de cepillos industriales y domésticos, artículos de limpieza y servicios de maquila industrial. Tenemos más de 40 años en este giro, nuestra misión es sobrepasar las expectativas de nuestros clientes en cuanto a sus necesidades de limpieza, proporcionándoles artículos de primera calidad a un costo competitivo en el momento y la cantidad que soliciten.

Nuestra visión: Asentarnos como la mejor empresa del mercado nacional para el año 2022, ofreciendo nuestros productos con una excelente calidad y al mejor precio

CONTACTO:

Emmanuel Rodríguez Castañón

Gerente General

811 243 8037

gruporoca@live.com.mx

MAQUINADOS. Piezas de nylamid.



Rodillo de nylamid



Tuercas de nylamid



Tornillos y Varillas de nylamid



Fabricaciones especiales

MAQUINADOS. Ranuro lateral de rodamientos.



RESORTES. Según muestra.

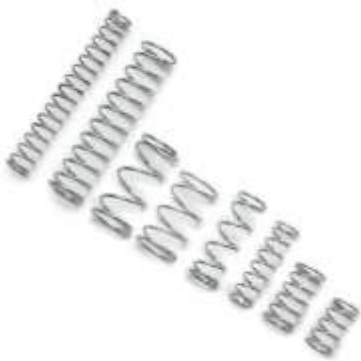

TORNILLERÍA. Acero, Inox, Galvanizado, Medias estándar milimétricos y especiales.



Machine Screws Head & Drive Types Availability



TORNILLERÍA. Acero, Inox, Galvanizado, Medias estándar milimétricos y especiales.



Wood Screws

Screws with a smooth shank and tapered point for use in wood. Abbreviated WS.



Machine Screws

Screws with threads for use with a nut or tapped hole. Abbreviated MS.



Thread Cutting Machine Screws

Machine screws with a thread cutting (self tapping) point.



Sheet Metal Screws

Fully threaded screws with a point for use in sheet metal. Abbreviated SMS.



Sex Bolts

Sex bolts (also panel nuts or Chicago bolts) have a female thread and are used for through bolting applications where a head is desired on both sides of the joint.



Mating Screws

Mating screws have a shoulder that matches the diameter of the sex bolts they are used with.



Self Drilling SMS

A sheet metal screw with a self drilling point.



Hex Bolts

Bolts with a hexagonal head with threads for use with a nut or tapped hole. Abbreviated HHMB or HXBT.



Carriage Bolts

Bolts with a smooth rounded head that has a small square section underneath.



Lag Bolts

Bolts with a wood thread and pointed tip. Abbreviated Lag.



J-Bolts

J shaped bolts are used for tie-downs or as an open eye bolt.



U-Bolts

Bolts in U shape for attaching to pipe or other round surfaces. Also available with a square bolt.



Hanger Bolts

Hanger bolts have wood thread on one end and machine thread on the other end.



Socket Screws

Socket screws, also known as Allen Head, are fastened with a hex Allen wrench.



Set Screws

Machine screws with no head for screwing all the way into threaded holes.



Eye Bolts

A bolt with a circular ring on the head end. Used for attaching a rope or chain.



Eye Lags

Similar to an eye bolt but with wood threads instead of machine thread.



Shoulder Bolts

Shoulder bolts (also known as stripper bolts) are used to create a pivot point.



Elevator Bolts

Elevator bolts are often used in conveyor systems. They have a large, flat head.

Types of Screws Heads



Flat Head Screw



Bugle Head



Oval or Raised Head



Pan Head



Button Head



Round Head



Truss Head



Binding Head



Fillister Head



Flange Head



Socket Head

MAQUILA. Clip TEE POST

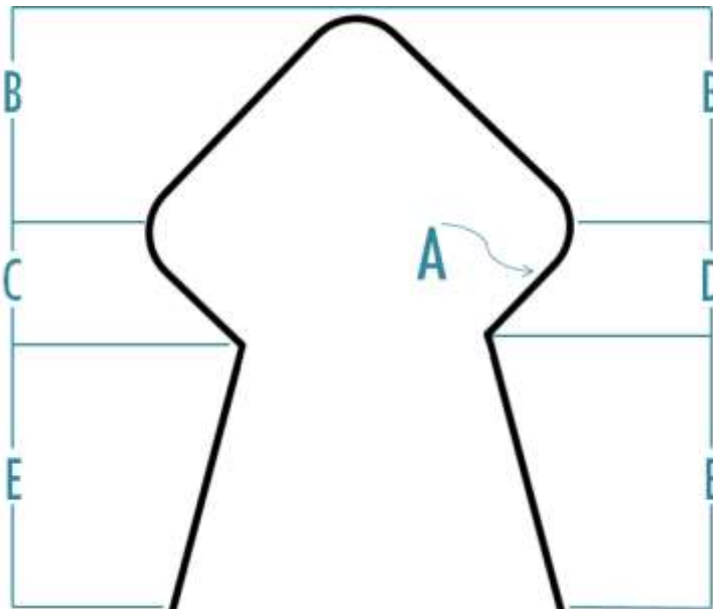

Código	A	B	C	D	E
	Alambre 11ga	45 mm	25 mm	10 mm	40 mm

MAQUILA. Clip REDONDO

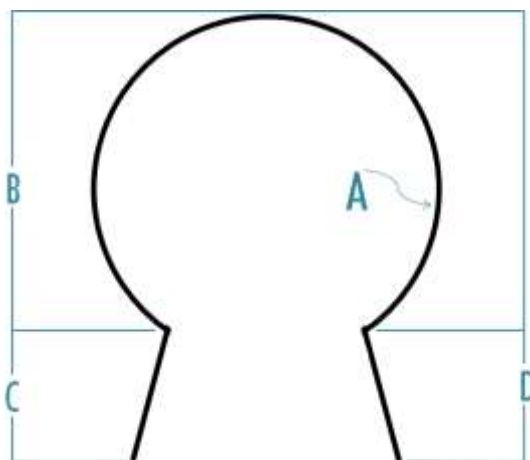

Código	A	B	C
	Alambre Calibre 9	44 mm	40 mm
	Alambre Calibre 9	51 mm	40 mm
	Alambre Calibre 9	64 mm	40 mm

Código	A	B	C
	Alambre Calibre 9	79 mm	40 mm
	Alambre Calibre 9	92 mm	40 mm
	Alambre Calibre 9	105 mm	40 mm
	Alambre Calibre 9	156 mm	40 mm

MAQUILA. Clip REDONDO

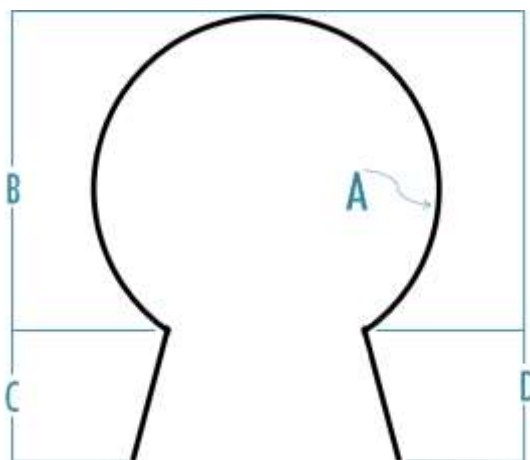

Código	A	B	C
	Alambre Calibre 11	43 mm	40 mm
	Alambre Calibre 11	50 mm	40 mm
	Alambre Calibre 11	63 mm	40 mm

Código	A	B	C
	Alambre Calibre 11	78 mm	40 mm
	Alambre Calibre 11	91 mm	40 mm
	Alambre Calibre 11	104 mm	40 mm
	Alambre Calibre 11	155 mm	40 mm

MAQUILA. Clip GROUND CLOTH

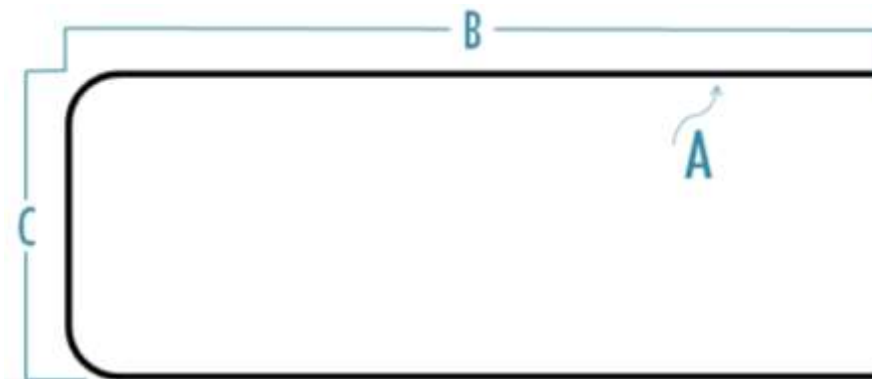

Código	A	B	C
	Alambre Galvanizado	153 mm	26 mm

MAQUILA. Clip FEEDER

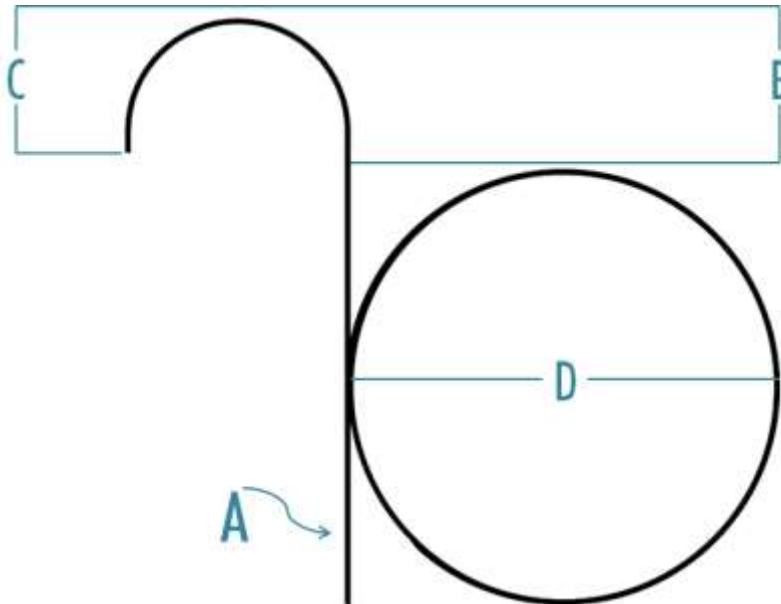

Código	A	B	C	D
	Galvanizado	12 mm	26 mm	20 mm

MAQUILA. Clip MALLA SUBMARINA

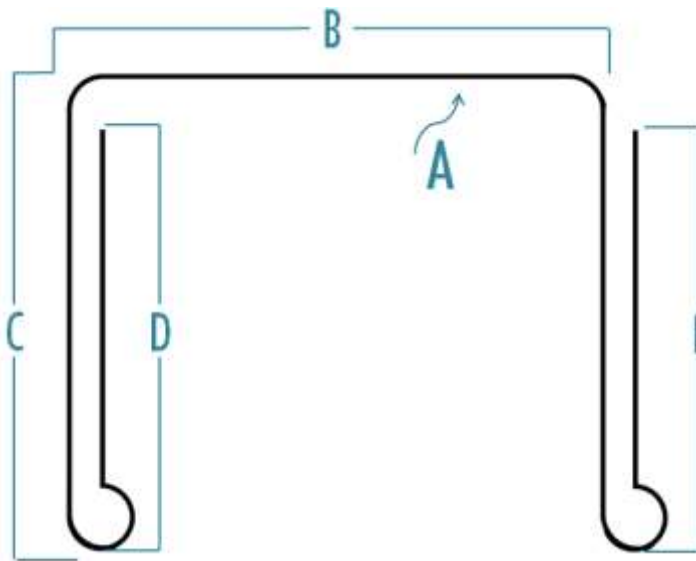

Código	A	B	C	D	E
	Galvanizado	134 mm	106 mm	90 mm	95 mm

MAQUILA. Carrete de Alambre USA

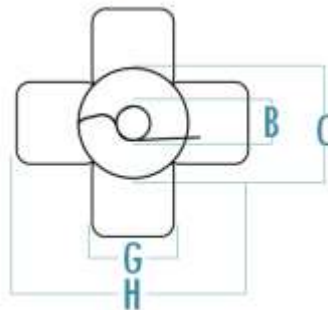
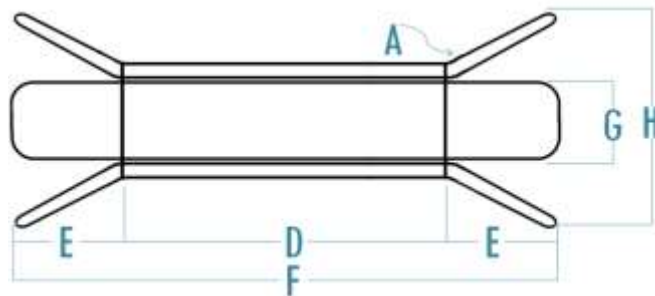
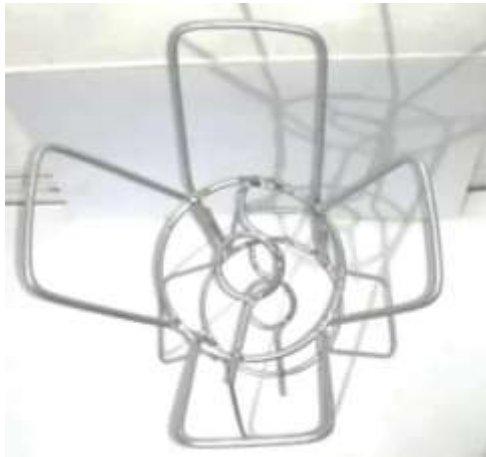

A	B	C	D	E	F	G	H
Galvanizado Calibre 6	4 cm	13.5 cm	19.5 cm	13.5 cm	46.5 cm	9.5 cm	25.5 cm

MAQUILA. Carrete de Alambre POTRERO

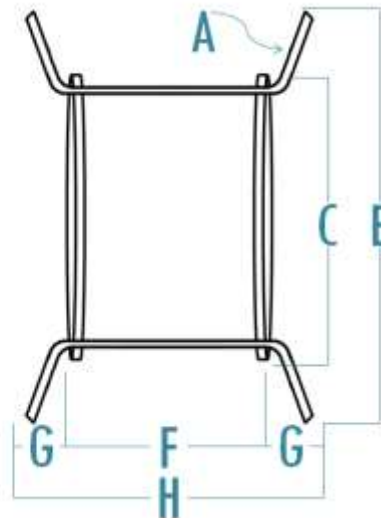
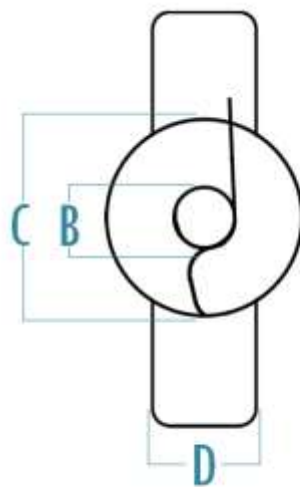

A	B	C	D	E	F	G	H
Galvanizado Calibre 6	4 cm	19 cm	9.2 cm	39 cm	17 cm	7 cm	31 cm

MAQUILA. Carrete de Alambre K

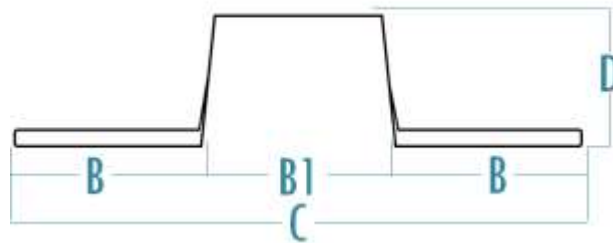
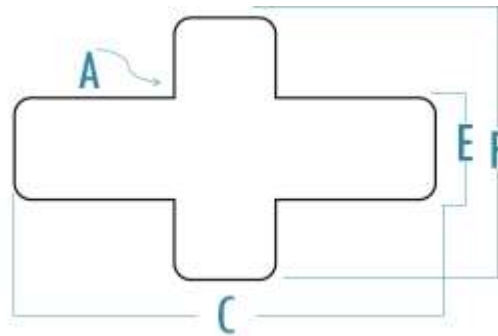

A	B1	B	C	D	E	F
Galvanizado Calibre 6	10.2 cm	16 cm	42.2 cm	10 cm	9.5 cm	22.5 cm



Contacto: Ing. Emmanuel Rodríguez

📞 (+52) 811 243 8037

✉️ gruporoca@live.com.mx

Este catálogo es sólo un ejemplo de los productos que manejamos. Trabajamos sobre especificaciones del cliente, dependiendo las medidas que necesite, ya que cada empresa maneja productos diferentes de acuerdo a sus necesidades.

CONTACTO:

Emmanuel Rodríguez Castañón

Gerente General

811 243 8037

gruporoca@live.com.mx